



## CGS-350.5XL

5 wheels cantilever carriage for gates



### FEATURES

- Monoblock body that ensures strenght to the struc-ture in **steel**
- Suitable to humid climate to avoid the carriage corrosion
- Double row angular shielded contact ball bearing to protect against dust suitable for temperatures from -30 ° C to + 80 ° C
- 4 support wheels for each carriage
- Alignment Central wheel
- Central rotation pin

AA (1 : 2)

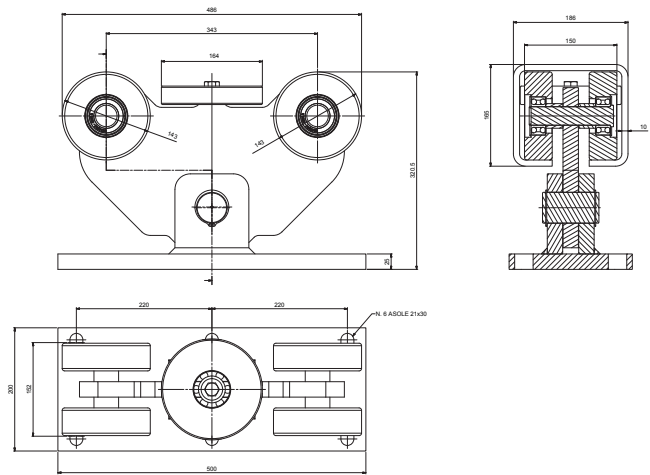

CODE	ART.	Size	Box info	
			Pcs per pack	Kg
10130043 001	CGS-350.5XL	XL	1	69

Finishing: Zincato / Galvanized

Commercial Category: 1Q

Minimum dimensions of the reinforced concrete casting

CGS 350.5XL (F1max=6500 Kg)								
Weight (Kg without monorail)	L=10 m		L=12 m		L=15 m		L=20 m	
	FA (M)	I (M)	FA (M)	I (M)	FA (M)	I (M)	FA (M)	I (M)
1500	5,00	2,40	5,00	3,0	5,90	4,14	8,20	6,40
2000	5,20	3,40	6,10	4,3	7,64	5,84	10,9	9,10
2500	6,60	4,80	7,80	6,0	10,0	8,20	14,7	12,9
3000	8,40	6,6	10,2	8,40	-	-	-	-

